

# Coleman

model 238B "Prince"

The Best of Its Kind!



all fuel safety-sealed

# Rapid-Lite

500 c.p.

kerosene lantern



- ★ 500 Candle-Power. Burns Kerosene and lights in a matter of seconds.
- ★ Also can burn Lighting-Petrol — with no adjustments needed.
- ★ New Coleman design Rapid-lite gives full burning radiance in 30 seconds.
- ★ Nickel-plated Brass Fount, tested to 200-lbs. pressure.
- ★ Positive shut-off Valve eliminates re-pumping each time lantern is lighted.
- ★ Built-in Cleaning Needle.
- ★ Highly polished, handsome aluminium ventilator.
- ★ Thermal shock-resisting glass globes.

will not blow out!



specifications

MODEL No.	DESCRIPTION	KIND OF FUEL	DIMENSIONS			NETT WEIGHT	OPERATION			QUANTITY BULK PACKED	SIZE OF BULK PACK			GROSS WEIGHT BULK PACKED
			Long	Wide	High		Capacity	Output	Duration		Long	Wide	High	
238B	"Prince" Rapid-lite 1 Mantle Lantern	Kerosene	-	Dia. 6"	14½"	5½ lbs.	2 pts.	500	7-8 hrs.	6	23¾ ins.	16½ ins.	16"	44 lbs.

# spare parts for 238B kerosene lantern

SAVE TIME AND MONEY BY QUOTING THE CORRECT PART NUMBER WHEN ORDERING

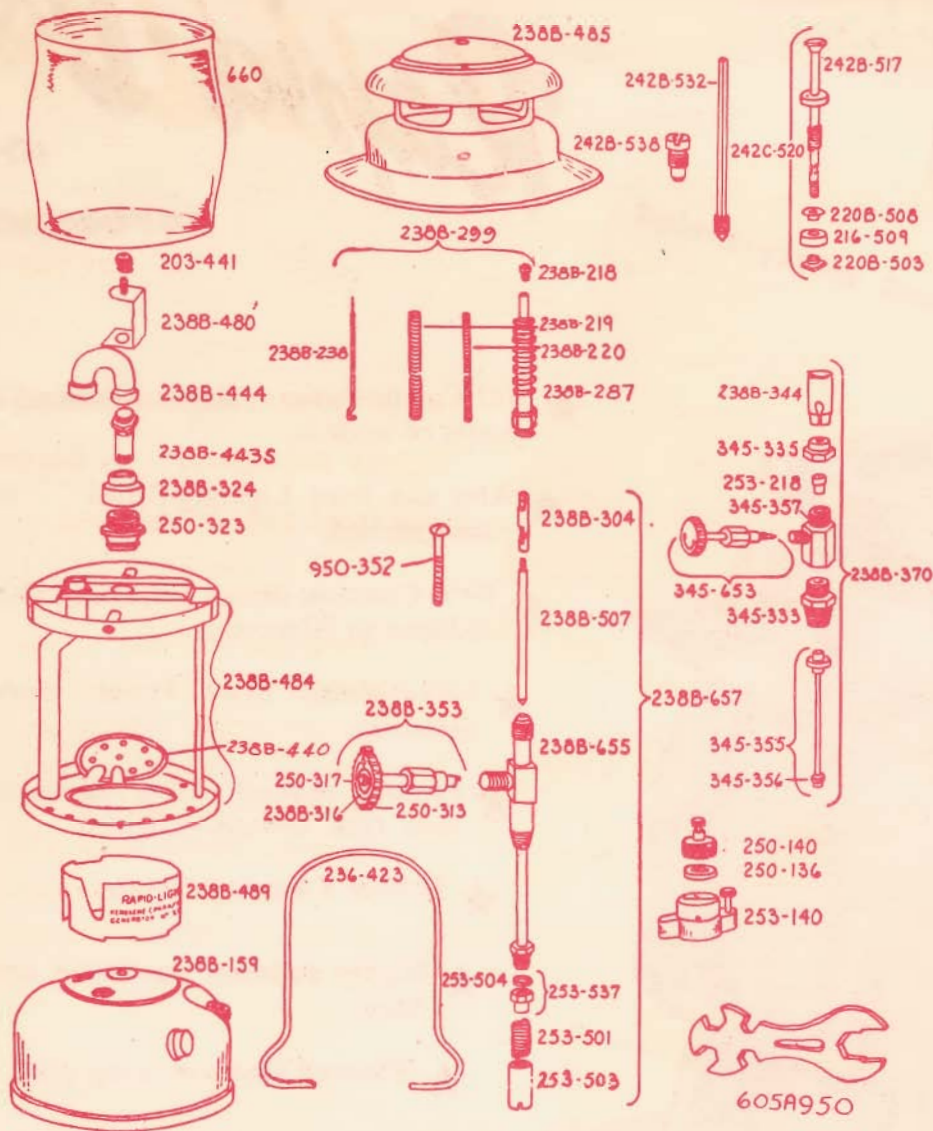

238B-299	Generator complete (See current price list)	242B-532	Air Stem
203-441	Ball Nut	242B-538	Pump Check Valve
216-509	Pump Leather	242C-520S	Pump Plunger Complete (less air stem)
220B-503	Pump Leather Nut	250-136	Filler Plug Gasket
220B-508	Leather Support Plate	250-140	Filler Plug Complete with gasket
236-423	Bail	250-313	Valve Wheel
238B-159	Fount (less Pump and Filler Plug)	250-317	Wheel Nut
238B-165	Fount (with Pump and Filler Plug)	250-323	Burner Cap
238B-218	Gas Tip	253-501	Valve Spring
238B-219	Generator Coil—Large	253-503	Valve Shell
238B-220	Generator Coil—Small	253-504	Rubber Valve Disc
238B-238	Generator Needle	253-537	Valve Retainer and Rubber Disc Assembly
238B-287	Generator Tube and Jamb Nut	530-504	Pump Cap
238B-304	Eccentric Block	605A-950	Wrench
238B-316	Valve Wheel Disc	950-352	Frame Screw
238B-324	Burner Cap Holder	660	Heat Resisting Glass Globe
238B-353	Eccentric Stem complete	1111	Mantle—500 Candle Power
238B-440	Centre Bottom Plate		<b>PARTS FOR RAPID LIGHTER</b>
238B-443S	Burner Tube with Lock Nut	238B-370	Rapid Lighter complete
238B-444	"U" Tube	238B-344	Blast Tube
238B-480	Burner Bracket complete	253-218	Gas Tip
238B-484	Burner Frame Assembly	345-333	Preheater connecting Nipple
238B-485	Ventilator	345-335	Gas Tip Cap
238B-489	Globe Base Rest	345-355	Mixing Disc and Fuel Tube assembly
238B-507	Push Rod	345-356	Screen and Holder
238B-655	Valve Body and Feed Tube	345-357	Preheater Valve Body
238B-657	Valve complete (less Generator)	345-653	Rapid Lighter Valve Stem Assembly
242B-517	Pump Rod and Handle		